

# Kenworth W900 Hood Repair



## Installation instructions for KENW900 repair kits

## KENW900R, KENW900S



W900R



W900S

### Tools and supplies required (not included):

- 1001-4 EcoPrep plastic cleaner
- Dust mask and gloves
- 60 to 80 grit sandpaper
- 50 grit Roloc™ discs and Roloc™ sander
- Drill with 1/8", 3/16", and 5/16" drill bits
- #2 Phillips head screwdriver
- 6118 Dual cartridge dispensing gun
- Body spreader or plastic putty knife
- 1/2" wrench

Congratulations on your purchase of Polyvance's Kenworth W900 hood repair kit for patching and reinforcing damaged hood mounts. With proper installation, the repair will last for years, saving you the cost of purchasing and installing a new hood.

Installation video:

<https://www.polyvance.com/Kenworth-Hood-Repair-Kits/KENW900R/>

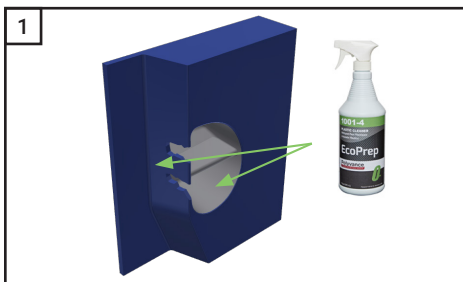

Using 1001-4 EcoPrep plastic cleaner, clean both pockets and the surrounding area where the reinforcing plate will be attached.

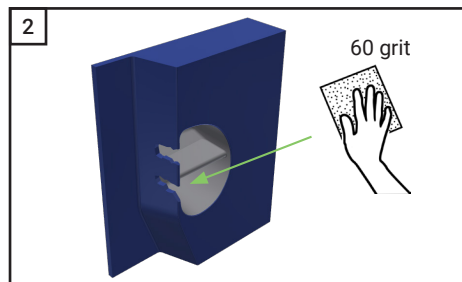

THOROUGHLY HAND SAND the inside of the pockets with 60 to 80 grit sand paper to roughen the surface and remove ALL paint.

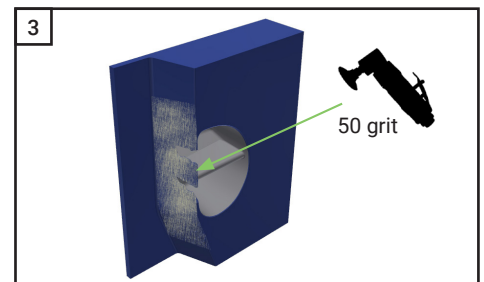

Grind the flat area where the bearing plates will be bonded with a 50 grit Roloc™ disc and blow dust free. Be sure all paint is removed.



Clean the outside of the reinforcing plugs with 1001-4 EcoPrep plastic cleaner.

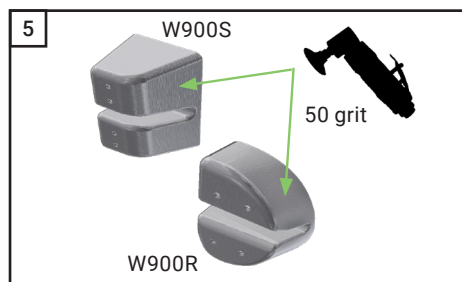

Thoroughly grind the outside surface of the plug with a 50 grit Roloc™ disc to make the aluminum receptive to PlastiFix adhesive.

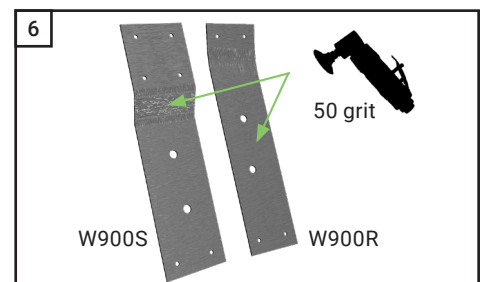

Grind the paint off of one side of the bearing plate to improve adhesion. Blow dust free. Do not clean with 1001-4 EcoPrep. Grind only the side that contacts the hood.

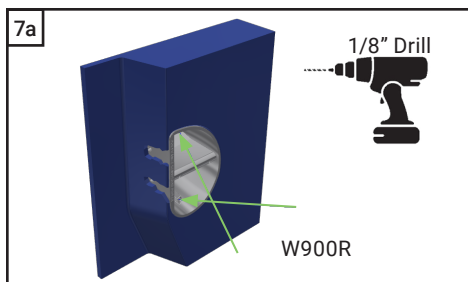

Drill two 1/8" pilot holes into the hood using the plug as a guide. On the curved plug, they are located halfway up the side of the plug.

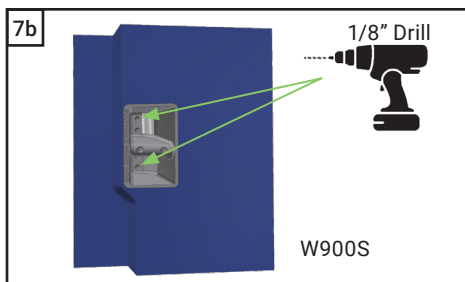

On the square plug, use the two outer-most holes on the bottom of the plug. Take care to not drill through both layers of plastic.

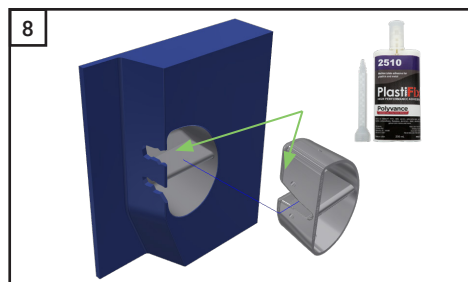

Spread a generous layer of 2510 PlastiFix evenly over the plug and inside the socket. Working time is 15 minutes at 68°F (20°C).

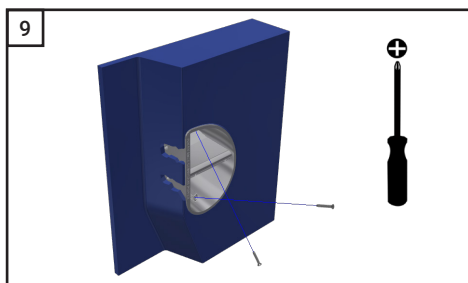

Install the plug & secure the plug into position with #10 wood screws. Wipe up excess adhesive with a gloved finger or spreader.

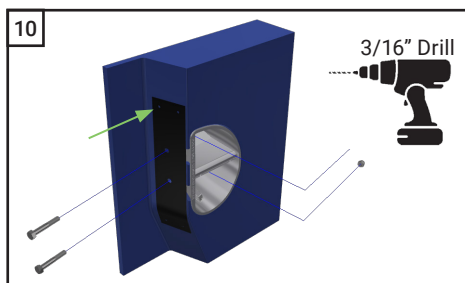

Using two 5/16" x 2" bolts as a guide for the matching bearing plate, drill the first 3/16" rivet hole into the hood.

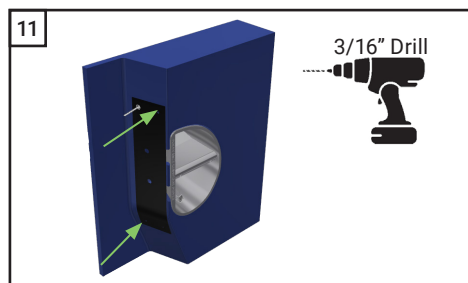

With a rivet temporarily placed in the first hole as a guide, drill the remaining rivet holes. Remove the plate, bolts, and rivet.

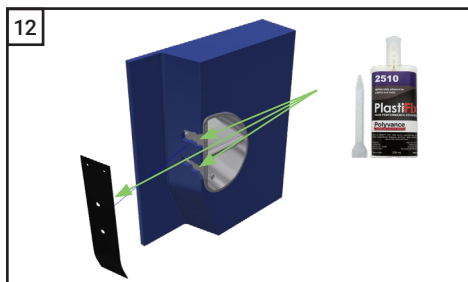

Fill the broken-out area of the hood with adhesive, then coat the sanded side of the bearing plate with adhesive.

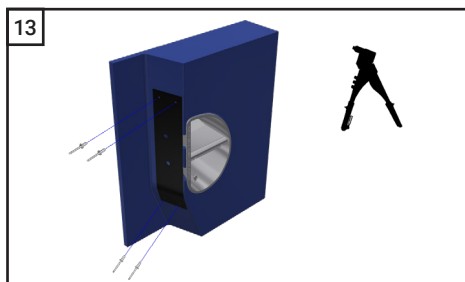

While pushing firmly down on the bearing plate, rivet the plate into place using the supplied 3/16" rivets, one in each hole.

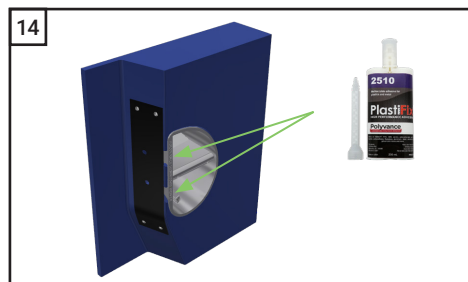

Fill the gap between the plate and the plug completely with PlastiFix. Clean up excess with a gloved finger or body spreader. Let cure for 2 to 4 hours minimum at 70°F. \*

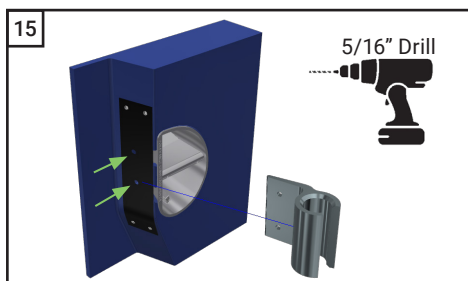

Re-drill the bolt holes with a 5/16" drill bit.

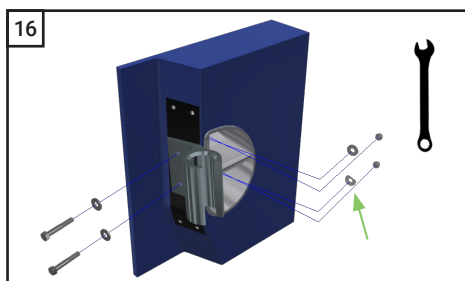

Install the hood brackets using the supplied 5/16" bolts, nuts, and washers. Use a flat washer under both the bolt head and lock nut. On the W900R, use the cut washer inside the plug as shown.

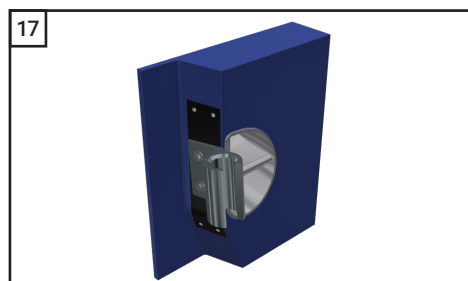

A job well done and ready for the road. Congratulations, you just saved a lot of time and money!

\* Maximum strength achieved in 24 hrs at room temperature.